

**Renovation of SCID mice facility (1<sup>st</sup> Floor) and Transgenic mice facility (Ground Floor) in Animal House**

TENDER DOCUMENTS

**NIT-05/2024**

FOR

**Renovation of SCID mice facility (1st Floor) and Transgenic mice facility (Ground Floor) in Animal House.**

AT

INTERNATIONAL CENTRE FOR GENETIC ENGINEERING & BIOTECHNOLOGY (ICGEB)

Aruna Asaf Ali Marg, New Delhi – 110067

Website: [www.icgeb.res.in](http://www.icgeb.res.in)

## Renovation of SCID mice facility (1<sup>st</sup> Floor) and Transgenic mice facility (Ground Floor) in Animal House

### INDEX

Sl. No.	Item	Page No.
1.	Tender notice	3
2.	Minimum Eligibility Criteria	5
3.	General terms and condition for submission of bid	6
4.	Scope of work	11
5.	Terms of Payment	12
6.	General terms and condition relating to works	14
7.	Technical Specification	16
8.	Annexures for Technical bid	17
	A Technical Bid Form	18
	B Undertaking declaration	20
	C Site visit certificate	21
9.	Price bid	22

## **Renovation of SCID mice facility (1<sup>st</sup> Floor) and Transgenic mice facility (Ground Floor) in Animal House**

**(1)**

### **TENDER NOTICE**

#### **INTRODUCTORY NOTE:**

ICGEB is an international organization dedicated to advanced research and training in molecular biology and biotechnology, with special regard to the need of the developing world. ICGEB, New Delhi Component has been given privileges and immunities as for other UN Organizations in India vide Government of India's gazette notification no. 216, SO 403(E) dated 12 April 1988.

ICGEB invites sealed Bids to meet the immediate requirement for "Renovation of SCID mice facility (1st Floor) and Transgenic mice facility (Ground Floor) in Animal House".

Interested & competent firm/individual may download the Bid documents from ICGEB website

## Renovation of SCID mice facility (1<sup>st</sup> Floor) and Transgenic mice facility (Ground Floor) in Animal House

### IMPORTANT INFORMATION

<b>Name of Work</b>	Renovation of SCID mice facility (1st Floor) and Transgenic mice facility (Ground Floor) in Animal House.
<b>Tender No.</b>	NIT - 05/2024
<b>Earnest Money Deposit (EMD) &amp; Tender Fee</b>	EMD of Rs. 3,00,000/- (Three Lakhs Rupees only) & Tender Fee of Rs2,000/- (Two Thousand Rupees only) in the form of separate demand draft to be drawn in favour of <b>International Centre for Genetic Engineering &amp; Biotechnology payable at New Delhi.</b>
<b>Distribution of Tender Document</b>	<b>To be downloaded from the website of the ICGEB</b> <a href="http://www.icgeb.res.in/ndinfo.htm">http://www.icgeb.res.in/ndinfo.htm</a>
<b>Pre bid</b>	8 <sup>th</sup> Apr, 2024 till 11:30 AM.
<b>Last Date and time for Bid Submission</b>	19 <sup>th</sup> Apr, 2024 till 3:00 PM
<b>Address at which Bid is to be submitted</b>	Should be dropped in the tender box at the reception of International Centre for Genetic Engineering & Biotechnology, Aruna Asaf Ali Marg, and New Delhi – 110067.
<b>Date, Time &amp; Place of opening of the Technical Bid</b>	19 <sup>th</sup> Apr, 2024 at 4:15 PM, ICGEB
<b>Date, Time &amp; Place of opening of the Financial Bid</b>	Technically qualified bidders will be called for financial bid opening
<b>Method of selection</b>	Both “Technical” and “Price” bid should be in separate envelopes and then put in to one common envelope, super scribing the name of the work and tender opening date etc. The Financial Proposals of the Firms/Individuals that qualify the Technical Evaluation will only be opened. Further, the Firm/Individual having the least quote (L1) in its financial proposal will be awarded the contract if the price bid is found to be in order.

**(2)**

**MINIMUM ELIGIBILITY CRITERIA**

The bidder should meet the following Eligibility Criteria and must submit documentary evidence in support of their claim for fulfilling the criteria and they should submit an undertaking on their official letterheads to the fairness of these documents while submitting the bid. The bids received without the documentary evidence will be rejected outright.

1. The bidder should have an address in Delhi/NCR.
2. Copies of the work order and completion certificate successfully executed for similar kind of work during the last 7 years preferably for reputed Public Ltd. Companies, Public sector, Govt. Institutions and autonomous bodies in the following manner.
  - A. The Bidder should have successfully completed one single assignment of similar kind of work for Rs. 1,20,00,000/- **OR**
  - B. Two similar work of Rs. 75,00,000/- each. **OR**
  - C. Three Similar work of Rs. 60,00,000/- each.
3. The bidder should have valid GST/TIN, registration certificates from relevant authorities (provide latest receipts/challans for documentary evidence).
4. The bidder should submit PAN number with documentary evidence
5. The Company / Firm / Individual, any Partners of the firm should not be black listed by any PSU or Government departments/ UN or its agencies/ institutions/ private organisations in respect of any assignments or behaviour of any Partner/ employee. The firm / Individual will provide an undertaking that such Partner/ employee will not be involved in the said contract, directly or indirectly.
6. An undertaking should be submitted that there are no legal suits / criminal cases pending against the Firm and its Proprietor/Partners or having not been earlier convicted on grounds of moral turpitude or for violation of laws in force.

**(3)**

**GENERAL TERMS AND CONDITIONS FOR SUBMISSION OF THE BID**

**Note: Bidders must read these conditions carefully and comply strictly while submitting their bids.**

**1. PREPARATION AND SUBMISSION OF THE BID DOCUMENT:**

The Bidder is expected to examine all instructions, forms, terms & conditions and specifications stated in the Bid Documents. Failure to furnish all information required in the Bid Document or submission of a Bid not substantially responding to the Bid Documents in every respect will be at the Bidder's risk and may result in the rejection of the Bid. The following sections of the Bid Documents must be completed and submitted by the Bidder:

**2. TECHNICAL BID should contain the following:**

**Note: All the Annexures to be filled properly and neatly.**

- a. Technical Bid Form (Annexure-A)
- b. Certificate of registration (GST, PAN).
- c. Documentary evidence for minimum qualifying criteria.
- d. Tender Fee of Rs. 2,000/-.
- e. EMD of Rs. 3,00,000/-.
- f. Undertakings / declaration certificates (Annexure -B)
- g. Complete Tender document (except price bid) duly sign and stamp on each page as a token of acceptance
- h. Site Visit certificate (Annexure-C)

**3. FINANCIAL / PRICE BID:**

In this bid the bidder is required to quote his items rates/prices for the works mentioned in the scope of work & technical specifications. The rates/price should be inclusive of all material cost, labour, services, charges for the plant/machinery/tools & tackles required for work, freight, Insurance, Govt. duties, excluding GST. If the tax rates are not shown separately, it will be deemed to be included in the quoted price and dealt with, accordingly.

## Renovation of SCID mice facility (1<sup>st</sup> Floor) and Transgenic mice facility (Ground Floor) in Animal House

Quoted rates will be deemed to cover all the items & works which may be required for completeness and functioning of total system, even though they may not have been explicitly mentioned in the scope and schedule of works.

No charges towards price escalation, site difficulties shall be payable extra or separately. It is mandatory on bidder to quote all items rate as asked for in the BOQ/ PRICE schedule. Failure to adhere to this condition will lead to rejection of tender.

#### 4. **EARNEST MONEY DEPOSIT& TENDER FEE:**

Earnest money deposit amount equivalent to Rs. 3,00,000/- (Three Lakhs Rupees only) & Tender Fee of Rs2,000/- (Two Thousand Rupees only) in the form of DD issued by any Commercial Bank in favour of International Centre for Genetic Engineering & Biotechnology payable at New Delhi must accompany the Technical Bid. The E.M.D. of successful bidder shall be released after submission of performance guarantee by him. Bids not accompanied by E.M.D. shall be rejected. E.M.D. of unsuccessful Bidders will be returned as early as possible. The E.M.D. shall be forfeited if a Bidder withdraws its Bid during the period of validity of the tender.

5. **PERIOD OF VALIDITY.** Bids shall remain valid for **180 days** after last date for bid submission prescribed by ICGEB which may be extended with mutually agreed terms. A bid valid for a shorter period may be rejected by ICGEB as non-responsive.

#### 6. **SITE VISIT:**

Interested Bidders may visit the ICGEB Campus before submission of the bid. For site visit, please contact Mr. Naresh Chand Dabral Component In-charge, Tel: 26741358, 26742357, Email ID: [ncdabral@icgeb.res.in](mailto:ncdabral@icgeb.res.in) on any working day (Monday to Friday) between 10:00 to 17:00 hours.

7. **SITE CONDITION:** Before quoting, the contractor must visit the site to inspect the work and shall fully acquaint himself about the conditions and scope of work with regard to accessibility of site required for the satisfactory execution of work along with site visit certificate No compensation on account of any site difficulties will be entertained, at a later date, after award of the works.

8. **Tender Rejection:** ICGEB reserves the right to reject any or all the tenders in full or in part without assigning any reasons whatsoever, and the decision of the centre in this regard will be binding on all the bidders. Tenders not complying with any of the provisions stated in this tender document are liable to be rejected. Director, ICGEB reserves the right to accept or reject any tender without assigning any reason and does not bind himself to accept the lowest tender.

#### 9. **FORMAT AND PREPARATION OF THE BID:**

1. The Bidder shall prepare the Technical Bid and Financial Bid and place them in two separate sealed covers, clearly marking each as "Technical Bid" and "Financial Bid". Name of firm / proprietor, address & contact no. should be mentioned clearly on both the envelopes. These should further be placed in a large size envelope with the same information on it. Both Technical & Financial Bids,

## **Renovation of SCID mice facility (1<sup>st</sup> Floor) and Transgenic mice facility (Ground Floor) in Animal House**

along with documents required to be submitted, shall be signed by the Bidder and a person duly authorized by the Bidder to, on each page. Written power of attorney accompanying the Bid shall indicate necessary authorization. Any correction in the Bid shall be initiated by the person signing the Bid.

2. All entries in the Application form should be legible and filled clearly. If the space for furnishing information is insufficient, a separate sheet duly signed by the authorized signatory may be attached.
3. No deviations in respect of NIT conditions are acceptable.
4. ICGEB reserves the right to visit the working sites mentioned by bidders as proof of experience to ascertain the quality of service rendered. The bidder will have to arrange for such visit.

### **10. SUBMISSION OF BID:**

The Bid in two parts, one containing the Technical Bid and the other containing the Financial Bid shall be placed in two separate sealed envelopes clearly marked as below:

- i. "Bid for Renovation of SCID mice facility (1st Floor) and Transgenic mice facility (Ground Floor) in Animal House - Technical Bid".
- ii. "Bid for Renovation of SCID mice facility (1st Floor) and Transgenic mice facility (Ground Floor) in Animal House - Financial Bid".

The sealed envelope having the Technical Bid shall contain the Technical Bid Form, Declaration Certificates, Demand drafts for Tender fee and E.M.D, documents establishing eligibility of offered services and a complete set of the Bid Document stamped & signed on all the pages etc.

The other sealed envelope will contain the Financial Bid which shall include Schedule of Rates.

Both the sealed envelopes containing the Technical Bid and Financial Bid separately, shall be placed in an outer envelope dully sealed, marking the outer envelope as "Renovation of SCID mice facility (1st Floor) and Transgenic mice facility (Ground Floor) in Animal House". The Bid shall be dropped in the tender box at the reception of, ICGEB, Aruna Asaf Ali Marg, New Delhi – 110 067.

If the cover containing the Bid documents is not sealed and marked as instructed above, no responsibility will be assumed for any misplacement of the Bid or beforetime opening of the envelope

### **11. IMPORTANT NOTE:**

1. Bid received through email and/or after the scheduled date and time will not be accepted.
2. ICGEB reserves the right to accept any or reject all the tenders without assigning any reason thereof.
3. Selection will be done on competitive basis. Canvassing in any manner shall lead to disqualification of the Firm / Individual.

### **12. BID OPENING**



## **Renovation of SCID mice facility (1<sup>st</sup> Floor) and Transgenic mice facility (Ground Floor) in Animal House**

All the Technical Bids shall be opened publicly in the presence of the Bidders or their representatives in front of the Bid Evaluation Committee. Bidders' name, documents with presence and absence of Bid security, period of Bid validity and such other items will be announced and recorded at the time of opening of the Technical Bid by the Bid Evaluation Committee. The Financial Bids of Technically Responsive Bidders will be opened in the presence of such responsive Bidders or their representatives on date and time to be notified later. Total Bid amount will be announced and recorded at the opening of the Financial Bid. Minutes of the Bid Opening containing summary of information with regard to each Bid shall be prepared during the opening of both Technical & Financial Bids.

### **13. EVALUATION OF BIDS:**

1. For proper evaluation & comparison of Bids, the Bid Evaluation Committee, may at its discretion, ask the Bidder for any clarification of the Bid. The request for clarification and the response shall be in writing, but no changes in the price of the Bids shall be offered or permitted.
2. The technical bids will be evaluated by the Bid Evaluation Committee on the basis of experience in similar organizations, resources available with the firm/ Individual, visit of the Committee to the site where the contractor is currently handling similar work etc.
3. The Bid Evaluation Committee will first evaluate the Technical Bids to determine the substantial responsiveness of the Technical Bids. Substantial Responsive Bid is one which conforms to all the terms and conditions as indicated in the Bid Document and which also establishes Bidder's qualification to deliver the services according to technical specifications. After the evaluation of all the Technical Bids, Financial Bids corresponding to only substantial responsive Technical Bids will be taken up for evaluation.
4. All non-substantial Technical Bids will be rejected as non-responsive and corresponding Financial Bids shall be excluded from further evaluation.
5. The Bid Evaluation Committee, may at its discretion, decide to waive off any minor non conformity in a Bid which does not constitute a material deviation with regard to services and pricing.
6. While evaluating Financial Bids, if there is any discrepancy between the unit price and the total price, unit price will prevail and total price shall be corrected. However, if the Bidder does not accept the correctness of the errors, his Bid will be rejected.
7. The Bidder must have supplied the information required in the Bid document. A Bidder not fulfilling any criteria stipulated, his Bid will be considered non responsive and may be rejected.
8. The Bidders who have duly complied with the Eligibility Criteria will be eligible for further processing.
9. The successful bidders of the Technical Bids will qualify for opening of the Financial Bids.  
The Bids which have been established as responsive in all respects will be compared for its price competitiveness. On the basis of technical and financial evaluation, substantially responsive and most

## **Renovation of SCID mice facility (1<sup>st</sup> Floor) and Transgenic mice facility (Ground Floor) in Animal House**

advantageous Bid will be considered for the award of contract for Renovation of SCID mice facility (1st Floor) and Transgenic mice facility (Ground Floor) in Animal House.

14. THE BIDDER IS EXPECTED TO EXAMINE ALL INSTRUCTIONS, forms, terms and conditions in the bidding documents. Failure to furnish all information required in the bidding documents or submitting a Bid not substantially responsive to the bidding documents in any respect may result in the rejection of the Bid.
15. THE BIDDER SHALL BEAR ALL THE COSTS associated with the preparation and submission of its bid, and ICGEB in no case will be responsible or liable for these costs, regardless of the conduct or outcome of the bidding process.
16. PROFESSIONAL EXCELLENCE AND ETHICS: ICGEB requires that all Bidders participating in this Bid adhere to the highest ethical standards, both during the selection process and throughout the execution of the contract.
17. FAILURE OF THE SUCCESSFUL BIDDER to comply with all the requirements shall constitute sufficient grounds for the annulment of the award, in which event ICGEB may make the award to the next lowest evaluated bidder or call for new bids.
18. THE TENDERING AUTHORITY RESERVES THE RIGHT TO ACCEPT ANY BID not necessarily the lowest, reject any bid without assigning any reasons for entering into the Rate Contract.
19. **CONDITIONAL BIDS:** If a bidder imposes conditions, which is in addition to or in conflict with the conditions mentioned herein, his bid is liable to be summarily rejected.
20. The Director, ICGEB reserves the right to cancel any or all the tenders without assigning any reason.
21. Tender once submitted will remain with ICGEB and will never be returned to the bidders.

### **22. ARBITRATION/RESOLUTION OF AND JURISDICTION**

Any dispute arising out of this contract will be in accordance with the principle of international laws.

(4)

### Scope of Work

Scope of Work is Renovation of SCID mice facility (1<sup>st</sup> Floor) and Transgenic mice facility (Ground Floor) in Animal House in accordance with drawing (attached here with), bill of quantities (attached) in price bid and Technical specification.

**Note:** The selected bidder will work in coordination with animal house in-charge and carry out the work so that the existing breeding and ongoing mice experiments do not suffer.

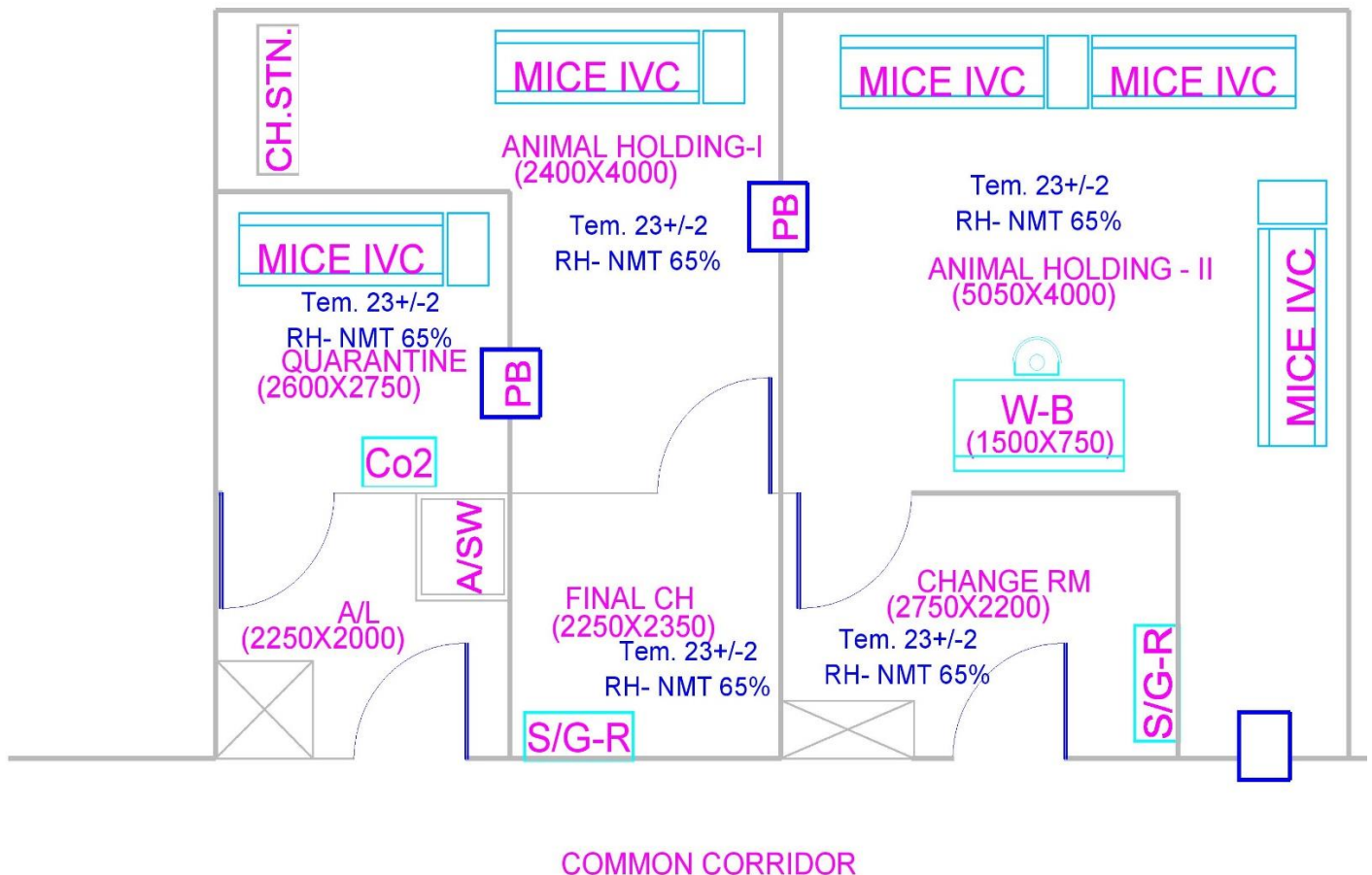

Technical specification and Drawing SCID mice facility 1<sup>st</sup> Floor in Animal House.

(5)

**TERMS OF PAYMENT**

1. **Escalation:** No escalation over and above items rates quoted by the bidder shall be paid during the execution of contract due to whatsoever reasons.
2. **Performance Guarantee @5%** shall be deposited to the department on the work order amount by the agency within a period of 15 days from the date of issue of LOI (work order) before commencement of work. Performance guaranty shall only be acceptable in the form of bank guarantee /DD and it will be returned after successful completion of work. (Date of completion certificate issued by ICGEB)

If tenderer fails to deposit the said performance security within the period as indicated, the Earnest Money deposited by the tenderer shall be forfeited automatically without any notice to the tenderer and without prejudice to any other right or remedy. Performance Bank guarantee shall be valid for entire contract period and two extra months. In case of con-tract extension with or without LD the validity of BG shall also be extended for the extended period with additional two months.

- **FORFEITURE:** Performance Bank guarantee shall contain a statement that it shall be automatically and unconditionally forfeited without recourse and payable against the presentation by ICGEB to the relevant company/ correspondent bank, as the case may be, together with a simple statement that tenderer has failed to comply with any term or condition set forth in the Contract.
  - **RELEASE:** Performance Bank guarantee will be released without interest on successful taking over of the project by ICGEB on receipt of written request from tenderer.
3. **Security deposit of 10 %** will be deducted from the Contractors bills and same will be released after successful expiry of defect liability of 12 months from date of completion of Work.
  4. **Payment of bills:**
    - a. 60% payment will be released against supply of material at site in good condition on pro-rata basis.
    - b. Balance final payment will be released after satisfactory completion of the work including testing & commissioning after deduction of 10% security deposit from the bill.
  5. **Extra Items:** - During the execution of work, the contractor may require to execute certain additional/extra items in order to complete the job/works beyond the BOQ for which no rates are available. The payment for such extra/deviated items shall be paid as per rate approved on the basis of analysis. The cost component for rate analysis shall be (i) cost of material (ii) cost of direct labour (iii) Contractor over heads & profit 10%. Before execution of

## Renovation of SCID mice facility (1<sup>st</sup> Floor) and Transgenic mice facility (Ground Floor) in Animal House

extra work, the rate analysis may be forwarded to ICGEB for approval of the Director, ICGEB. However, the extra items amount should not exceed 10% of the total contract value including all taxes.

6. **Guarantee/Defect Liability Period:** The contractor should guarantee for the works / items executed by him against the bad material / workmanship for a period of one year from the date of acceptance by ICGEB. During this period if any replacement of items and/or repairs / rectification is needed, the same should be replaced / repaired free of cost to ICGE
7. **Liquidated Damage:** In case the work is delayed beyond the specified completion period for reasons attributed to the contractor, deductions on account of Liquidated damages @ 1 % of the contract value per week will be deducted subject to a maximum of 10% of the total contract value excluding GST. However, in case the works are delayed beyond the schedule completion/contract period, ICGEB reserves the right to get the work done by any other contractor at the risk and cost of the contractor and amount to this affect along with 10% over heads will be deductible from his bills/dues.
8. Rates quoted by bidder in 'Price Bid' will be item rates i.e. will be all inclusive including material, labour, cartage, tools, tackles, all access ladders & scaffolding, (all taxes excluding GST), Contractors overhead profit and all other expenses not specifically mentioned but reasonably implied.

(6)

**GENERAL TERMS AND CONDITIONS RELATING TO WORKS**

- 1. Completion Time:** Time limit for completion of the work is 90 days from the date of the order issued. The time shall be the essence of this contract and entire work as titled above is to be completed in all respects within the given time from the date of issue of work order. The successful bidder has to submit the time & activity chart for the completion of work.

Under the force-major conditions or delay due to reasons beyond control of the contractor, ICGEB may grant suitable time extension for which the contractor has to request along with the justification/ reasons well in advance to the Director, ICGEB for approval without any prejudice to price escalation. No time extension request shall be considered after the expiry of completion period of contract. The decision of the Director will be final and binding on the bidder/contractor.

- 2.** Kindly note that payment shall be made as per the actual quantities executed and not on the basis of materials supplied. The final payment will only be made on the basis of the actual work quantities executed and for this a joint measurement by ICGEB and the contractor will have to be taken. The responsibility and the facilitation for taking the measurements will rest with the contractor.
- 3.** The Work shall be done as per schedule of items, specification terms and conditions and instruction of Engineer-in-charge on as and when required basis.
- 4.** The rates shall be inclusive of cartage/ loading unloading or any other expenses. GST should be clearly shown separately. Rate must be valid and firm for a period of one year from the date of award of contract/Letter.
- 5.** Inferior and Poor quality material shall not be accepted and contractor will redo such works
- 6.** The contractor will have to undertake COMPLETE responsibility of accidents etc. for his persons working on site. ICGEB shall not be held liable for any injuries or damages. Also, any damage to any ICGEB property due to the actions of the contractor or its employees shall be compensated by the contractor”.
- 7.** The Contractor shall clean the site after completion of work before submission of final bill. Any dismantled material shall be stacked in designated place as instructed by the Engineer-in-charge.
- 8.** Charges for scaffolding or jhula if any, will be considered included in the quoted rates and no extra amount will be paid on this account.
- 9.** Measurement shall be taken jointly by the Engineer-in-Charge or his authorized representative and by the contractor or his authorized representative.
- 10.** All materials brought at site shall be got approved from the Engineer in charge before incorporation.

## **Renovation of SCID mice facility (1<sup>st</sup> Floor) and Transgenic mice facility (Ground Floor) in Animal House**

- 11.** Contractor shall carry out the various tests as enumerated in CPWD/BIS specification at his own cost.
- 12.** Quantities are indicative and likely to vary. Bidder will have no objection for variation in quantities thereon. Payment will be as per actual work executed. 10%±deviation in quantities would be permitted.
- 13.** In case the bidder withdraws his offer within the validity of tender or contractor fails to work as per contract terms & conditions specifications after issue of the award letter, the earnest money will be forfeited. Other suitable administrative punitive action may also be imposed as deemed fit.
- 14.** Contractor should depute a qualified supervisor dedicated for this site, who will co-ordinate work and interact with the ICGEB representative responsible for supervision of work. Without a Supervisor, work will not be allowed. All the persons deployed at ICGEB site should carry valid gate-passes. Any negligence/offence on their part will attract immediate removal from site.
- 15.** The contractor will provide all necessary materials, tools, equipment, measuring instruments and working consumables etc., needed for execution of the works. Safe custody of all such material will be contractor's sole responsibility. No extra charges will be paid for the same.
- 16.** Watch and Ward of all material till the system is taken over by ICGEB shall be the sole responsibility of the contractor and pilferage etc. shall be entirely to his account.
- 17.** During execution of work, the contractor should follow all standard norms of safety measures / precautions to avoid accidents / damages to man, machines and buildings. On non-adherence of this clause, suitable fines as decided by the Director, ICGEB shall be imposed.
- 18.** Challan: No material belonging to the contractor whether consumable or non-consumable should be brought inside the ICGEB campus without proper entry at the main gate nor any material should be taken out without proper gate pass issued by the ICGEB. List of all inwards / outwards challan to be maintained by the contractor with a copy marked to ICGEB.
- 19.** ICGEB will provide free water and electricity during Renovation of SCID mice facility (1st Floor) and Transgenic mice facility (Ground Floor) in Animal House. The contractor has to make his own arrangements for distribution of power and water from that point as per his requirements.
- 20.** Termination of Contract: The Director, ICGEB reserves the right to terminate the contract on account of poor workmanship, failure to mobilise the site within 30 days, non-compliance of set norms/ specifications for the works, delay in progress of work, violation of any contract provisions by the contractor. In such case the contractor is liable to pay liquidated damages @ 10% of tendered value besides for failure of EMD.

(7)

## Technical Specifications

Technical Specifications of for each item of work will be in accordance with relevant IS codes and CPWD specifications unless noted otherwise.



**(8)**

## **ANNEXURES FOR TECHNICAL BID**

**Note: All the Annexures should be filled properly and neatly.**

## Renovation of SCID mice facility (1<sup>st</sup> Floor) and Transgenic mice facility (Ground Floor) in Animal House

Annexure-A

### Technical Bid Form

S. No.	Description.	Fill the detail	Page No. of documentary
1.	Name of Agency.		
2.	Name of the Contractor (Firm/Individual) and Contact Person.		
3.	Date of Incorporation of the Firm		
4.	Whether Proprietary / Partnership		
5	Office Address in Delhi NCR, Tel. Nos and Email ID:		
6	GST Registration details (with documentary evidence)		
7	PAN No. (with documentary evidence)		
8	One similar work of value not less than Rs.1,20,00,000/-.	1. Work order No. Date: Rs.	
9	Two similar works, each of value not less than Rs.75,00,000 each.	1. Work order No. Date: Rs. 2. Work order No. Date: Rs.	

**Renovation of SCID mice facility (1<sup>st</sup> Floor) and Transgenic mice facility (Ground Floor) in Animal House**

10	Three Similar works each of value not less than Rs. 60,00,000 each.	1. Work order No. Date: Rs. 2. Work order No. Date: Rs. 3. Work order No. Date: Rs.	
11	Completion certificate, if fully executed.		
12	Signed and stamped Tender document		
13	Tender Fee		
14	Earnest Money Deposit		
15	Undertaking for not black listed		
16	Site visit acceptance certificate (signed and stamped)		

Authorised Signatory  
Name & Address of the firm with seal

**UNDERTAKING/DECLARATION FOR NOT BEING BLACK LISTED**

Date.....

To,  
The Administrative Officer  
International Centre for Genetic Engineering & Biotechnology  
ArunaAsaf Ali Marg  
New Delhi – 110 067.

Dear Sir,

I / We ..... hereby confirm that our firm has not been banned or Blacklisted by any government organizations/Institutions/Court/Public sector Units/Private organization. Further it is certified that there is no police case pending against our firm/partner relating to previous service contracts.

Authorised Signatory  
Name & Address of the firm with seal

This certificate shall be furnished duly signed & stamped with Techno-commercial Bid.

**Site Visit Certificate/ Undertaking**

This is to certify that we have visited the site for work of **Renovation of SCID mice facility (1st Floor) and Transgenic mice facility (Ground Floor) in Animal House**. on ..... and assessed the actual situation & nature of site. We have also assessed the amount of work involved at site for tendered work before submitting our offer. We will be able to complete the above work within stipulated time as per site conditions.

We further undertake that no extra cost will be claimed by us later-on for any difficulties/ modifications involved during the execution of tendered works. We understand that work is to be executed in an already operational/ functional institute.

Component In-Charge  
ICGEB New Delhi

Authorised Signatory  
Name & Address of the firm with seal

**(9)**

# **PRICE BID**

**Renovation of SCID mice facility (1<sup>st</sup> Floor) and Transgenic mice facility (Ground Floor) in Animal House**

**PRICE BID (Schedule of Rate)**

Name of Work: Renovation of SCID mice facility (1st Floor) and Transgenic mice facility (Ground Floor) in Animal House.

S. No.	Description of work	Unit	Qty.	Rate	Amount
A	<b>Air Conditioning System</b>				
1	<b>Supply, installation, testing and commissioning of AHU 3500 CFM - -: TFA type 100% FA 140mmWG Static pressure Modular Outdoor TFA Double skin Air Handling Units of 43+/-2 mm thick PUF injected panels with 24 gauge GI inner skin and pre-coated GI outer skin all as per specification including fan with TEFC motor. AHU shall have Air intake louver combined with pre filter (EU-3), Fine Filter section (EU-9),HEPA filter section (EU-13), chilled water coil section with DX 6-Row coil, blower section with DIDW centrifugal fan having static pressure of 140 mm/Wg TWIN MOTOR ARRANGEMENT foundation, GI drainage complete as required. Make ; Waves, citizen, ZECO</b>	NO	01		
2	<b>SITC of exhaust system 4000 CFM Double skin EXHAUST Air Plenum of 25+/-2 mm thick PUF injected panels with 24 gauge GI inner skin and pre-coated GI outer skin all as per specification including fan with TEFC motor. EAU shall have Exhaust Damper, combined with HEPA filters (EU-13), blower section with INLET &amp; OUTLET Dampers TWIN MOTOR ARRANGEMENT foundation complete as required. Make; Waves, citizen, ZECO</b>	NO	01		
3	<b>SITC of following size Chiller piping MS C Class pipe with 32mm Nitrile Insulation and Aluminium Cladding 26 G/ UV Protection Coating , L bow,T,C channel, pipe supports complete as required.( Insulation Make; Armaflex, vidoflex)</b>				
3.1	<b>100 mm dia Make; Tata, Jindal</b>	Mtr	30		
3.2	<b>50 mm dia Make; Tata, Jindal</b>	Mtr	10		

**Renovation of SCID mice facility (1<sup>st</sup> Floor) and Transgenic mice facility (Ground Floor) in Animal House**

4	SITC of Pan Humidifier (SS-304) complete with SS Tank and Emerson Heaters of capacity 9 Kw electrical rating and connected distribution piping and mist-nozzles inside the AHU air stream, including GI piping for water connections, water high level low level sensors, over temperature cut out, drain line, required ball valves (Make zoloto, Unic) for smooth operation of the system, foundation complete as required. <b>Make;Rapid cool, KEPL</b>	No	O1		
5	<b>SITC of 3 WAY MOTORIZED VALVE linier type, Auto/Manual operation ,thermostat, interconnecting wires, flenges, nut, bolt, insulation with aluminium clading complete as required</b>				
5.1	<b>50 mm dia Make; SIEMENS, HONEYWELL</b>	No	1		
5.2	<b>32 mm dia Make;SIEMENS, HONEYWELL</b>	No	1		
6	<b>SITC of BUTTERFLY VALVE of following size flenges, nut, bolt, insulation with aluminium clading complete as required</b>				
6.1	<b>100 mm dia Make;Audco,Advance</b>	No	6		
6.2	<b>50 mm dia Make;Audco,Advance</b>	No	2		
6.3	<b>32 mm dia Make;Audco,Advance</b>	No	1		
7	<b>SITC of NRV 100 mm size flenges, nut, bolt, insulation with aluminium clading complete as required. Make;Audco,Advance</b>	No	2		
8	<b>SITC of Y type pipe line strainers of following size duly insulated and necessary fittings like flenges, nut, bolt complete as required</b>				
8.1	<b>100 mm dia Make;Audco,Advance</b>	No	3		
8.2	<b>50 mm dia Make;Audco,Advance</b>	No	1		



**Renovation of SCID mice facility (1<sup>st</sup> Floor) and Transgenic mice facility (Ground Floor) in Animal House**

8.3	<b>32 mm dia Make;Audco,Advance</b>	No	1		
9	<b>SITC of PRESSURE GAUGE 0-10 kg/sq cm,100mm dial size, SS syphan with ss ball valve fittings complete as required. Make;H Guru,Jaspin</b>	No	8		
10	<b>SITC of Mercury filled 'V' form thermometer with SS/browns body, thermo well for AHU complete as required. Make;H Guru,Jaspin</b>	No	8		
11	<b>SITC of Heavy duty isolating ball valve 1/2 inch with fittings for AHU water air purging complete as required. Make;Zoloto,Unic</b>	No	2		
	<b>Air Distribution System</b>				
12	<b>SITC of GI Ducting complete with MS painted flanges, all joints sealed with RTD silicon sealant with MS painted supports as per IS-266 with Zinc deposition 120gms/sqm</b>				
12.1	<b>GSS-24 Swg ducting including accessories and Support arrangement complete as required. Make;Jindal, TATA</b>	Sq.mt	50		
12.2	<b>GSS-22 Swg ducting including accessories and Support arrangement complete as required. Make;Jindal, TATA</b>	Sq.mt	30		
12.3	<b>Duct Insulation with 19 mm thick aluminum foil faced / Nitrile Class-O and alljoints shall be provided with 2" fixing tape complete as required. Make;Armaflex,vidoflex, Supreme</b>	Sq.mt	80		
12.4	<b>GI duct cladding withGSS-26 Swg sheet complete as required. Make;JintaL, TATA</b>	Sq.mt	80		
12.5	<b>S ITC of Aluminum Gear Operated volume control dampers suitable size with actuators with wiring for AHU and Exhaust systems f complete as required . Make;Caryair, Waves</b>	No	2		
13	<b>SITC of Ducted Heater arrangement 9 KW capacity for controlling the required RH and temperature as needed complete with necessary Thermostat &amp; Humidistat for operational control at AHUs (Supply air ducting) Make;Caryair/Waves/ KEPL</b>	NO	1		

**Renovation of SCID mice facility (1<sup>st</sup> Floor) and Transgenic mice facility (Ground Floor) in Animal House**

14	<p>Supplying, Fixing, testing and commissioning of fire dampers in supply air duct/ main branch and return air path as and where required of required sizes i/c control wiring, the damper shall be motorized and spring return so as to close the damper in the event of power failure automatically and open the same in case of power being restored. The spring return action shall be inbuilt mechanism and not externally mounted. The damper shall also be closed in the event of fire signal control wire should connected to the existing fire panel complete as required and as per CPWD specifications, wiring/power supply complete as required.</p> <p><b>Make;Caryair, Waves</b></p>	No	2		
15	<p>Extruded aluminum powder coated Supply/ Exhaust Air Diffusers with Black Matt Finish VCD complete as required.</p> <p><b>Make;Caryair, Waves</b></p>	Sq.mt	3		
16	<p><b>Electric Panel (Location; Animal house Terrace)</b></p>				

**Renovation of SCID mice facility (1<sup>st</sup> Floor) and Transgenic mice facility (Ground Floor) in Animal House**

	<p>Supplying, installation, testing &amp; commissioning of <b>CPRI Approved Manufacturer</b> cubical type floor mounted Distribution Panel suitable for <b>Outdoor application</b> for 415V, 3 Phase, 4Wire 50 Hz AC supply system fabricated in compartmentalized design from CRCA sheet steel of 2mm thick for frame work and covers, 3 mm thick for gland plates i/c cleaning &amp; finishing complete with 7 tank process for powder coating in approved shade, having 250 Amp capacity extensible type Aluminium bus bars of high conductivity, SMC bus bar supports, with short circuit withstand capacity of <b>50kA</b> with entire panel shall have a common earth bus of suitable size at the rear with 2 Nos earth stud, solid connections from main bus bar to switch gears with required size of Aluminium bus bars and control wiring with 1.5 sq.mm. PVC insulated FRLS copper conductor Single Core cable, cable alleys, cable gland plates. providing&amp; fixing following switch gears:-Foundation with C channel, cable gland, Thimble, cable termination complete as required.</p> <p>Electrical Component Make; ABB,L &amp;T,SCHNEIDER, Havells Electrical wire Make ;Finolex, Havells</p> <p><b>CPRI Approved Manufacturer</b></p>	NO	1		
a	INCOMER				
	<p>1 No. - 250 Amps Four Pole, 50 KA, MCCB with Thermal Magnetic release with O/C, S/C &amp; E/F protection release. Digital Voltmeter with in built VSS, with 2Amp. Back up MCB. 1 Set - 3 Nos. Phase indication LED lamps with 2Amp back up MCB, Breaker 'ON/OFF' indicating light with 2A MCB, test terminal block set, circuits as per standard practice, auxiliary contacts for positive interlocking of the breakers as required. - 2 Se1 No. Suitable energy meter,panel cooling fan with heater for humidity controlling. Each Panel will have Junction box with holes punched for connecting it to existing panel through Cable.</p>				
	<b>OUTGOING FEEDERS</b>				

**Renovation of SCID mice facility (1<sup>st</sup> Floor) and Transgenic mice facility (Ground Floor) in Animal House**

b	<p><b>Panel should following outgoing feeders each feeder should accommodate Auto /Manual operation within built VSS, with 2Amp. Back up MCB. 1 Set - 3 Nos. Phase indication LED lamps with 2Amp back up MCB, Breaker 'ON/OFF' indicating light with 2A MCB, test terminal block set, circuits as per standard practice, auxiliary contacts for positive interlocking of the breakers as required. - 2 Se1 No. Suitable energy meter . Each Panel will have Junction box with holes punched for connecting it to existing panel through Cable. Out going feeders suitable capacity for following equipments</b></p> <p><b>1) 200 A, 50K four poll BCCB for chiller o1 no.</b>  <b>2) 32 A RCCB for chiller pump 02 nos.</b>  <b>3) Suitable RCCB with panel space for Supply air VFD (UPS power) - 01no.</b>  <b>4) Suitable RCCB with panel space for Exhaust air VFD (UPS power) - 01 no.</b>  <b>5) Suitable RCCB for Pan humidifier - 01 no.</b>  <b>6) Suitable RCCB for Duct heater - 01 no.</b>  <b>7) 100 A four poll MCCB for UPS power - 01 no.</b></p> <p><b>Panel should accommodate 20KVA UPS power supply incomer with PDB including 32 A TPN 01 no and SP MCB 10 nos.</b>  <b>LDB including 32 A TPN 01 no and SP MCB 10 nos.</b></p>				
17	<p><b>Electrical power Cabling ; Supply &amp; Laying/ fixing of following size XLPE insulated and PVC sheathed Copper /Aluminium conductor armoured cable as required of 1.1 KV grade complete as required.(ISI Marked) (In ground/in pipe/in duct/on surface/ on cable tray) with all complete with cable tray clamps, saddles, thimble cable gland etc including effective proper connection to the equipment as required</b>  <b>Make;Finolex, Havells</b></p>				
17.1	4C X 10 mm <sup>2</sup> (copper)	Mtr	50		
17.2	4C X 6 mm <sup>2</sup> (copper)	Mtr	50		
17.3	3C X 4 sq.mm (Black, Green & Any Phase Colour) (copper)	Mtr	100		
17.4	4C X 4 sq.mm (Black, Green & Any Phase Colour) (copper)	Mtr.	100		

## Renovation of SCID mice facility (1<sup>st</sup> Floor) and Transgenic mice facility (Ground Floor) in Animal House

17.5	3C X 4 sq.mm multi strand cable (Black, Green & Any Phase Colour) (copper)	Mtr.	200		
17.6	3C X 2.5 sq.mm multi strand cable (Black, Green & Any Phase Colour) (copper)	Mtr.	200		
17.7	3C X 1.5 sq.mm multi strand cable (Black, Green & Any Phase Colour) (copper)	Mtr.	200		
17.8	4C X 35 mm <sup>2</sup> (aluminium) for UPS power	Mtr.	100		
<b>18</b>	SITC of modular type 16 A power sockets complete as required. <b>Make; Havells,Honeywell</b>	Nos	10		
19	SITC of Variable Frequency Drive (VFD) ACS 310 with IP 55 protection and enclosure&Ehhaust air ventilation fan - ABB Control wiring ,MCB complete as required. Make; ABB,DANFOSS	No	2		
20	SITC of new set of 2x18 watt LED light and fixtures wiring complete as required <b>Make; Philips, Havells</b>	No	20		
21	<b>CLEAN lab interior &amp; clean room</b>				
21.1	SITC of Double skin Clean room <b>Wall Cladding, Wall Partition Panel system 80 mm thick</b> , PUF infilled powder coated GI sheet, as per specification complete with concealed conduits for power socket, data, telephone points and necessary cut-outs for double gazed view panels and doors. <b>Make; GMP, Fabtech, Synergy</b>	Sq.mt	30		
21.2	<b>SITC of Double skin powder coated GI sheet, PUF infilled, Walkable Clean room Ceiling system 50 mm thick</b> , including necessary utility cut-outs duly concealed, as per specification, including necessary utility cut-outs duly concealed, as per specification. <b>Make; GMP, Fabtech, Synergy</b>	Sq.mt	20		
21.3	SITC of <b>2.5 mm thk. EPOXY flooring</b> complete as required. <b>Make;ARDEX,EPOXY/</b>	Sq.mt	60		
21.4	SITC of R-35 PVC progressive floor to wall coving suitable for EPOXY floor finish. <b>Make;Wonderfloor,RMG</b>	RMT	50		

## Renovation of SCID mice facility (1<sup>st</sup> Floor) and Transgenic mice facility (Ground Floor) in Animal House

21.5	SITC of Wall to ceiling and Wall to wall coving with PVC / Extruded aluminium powder coated (R= 42) clutch-coving with silicon finish <b>Make;Fabtech,clean room systems, Synergv</b>	RMT	50		
21.6	SITC of Clean room compatible double Leaf Doors 1200 (W) x 2100mm (H) as per specification with door closure, SS-'D' handle, Push plate and kick plate along with 480x750 double glazing view pane & Drop-seal <b>Make;Fabtech,clean room systems, Synergy</b>	No	1		
<b>Automation &amp; Access Control system</b>					
22	Building Management System and Controls:  A customized Building Management System shall be designed and provided to control the operation of HVAC system and to monitor the laboratory operating parameters in the Lab rooms/zones pressure, supply air quantity in each room, BSC Cabinet status, AHU status, exhaust blower status, VFD status, Room temperature, differential pressure & RH. The BMS Control System shall comprise of: <ul style="list-style-type: none"> <li>a) BMS computer</li> <li>b) Software</li> <li>c) VFD for Air Handling Units and Exhaust Blowers</li> <li>d) Air Flow Control Valve with Integral Airflow Measurement for animal room.</li> <li>e) Motorized Dampers with Open /Close Actuator for BSC Exhaust Blowers</li> <li>f) Fresh Air Damper with Proportionating Actuator</li> <li>g) Return Air Damper with Proportionating Actuator</li> <li>h) Exhaust Air Damper with Proportionating Actuator</li> <li>i) Pressure, Temperature &amp; RH Sensors in each Room. System with complete wiring and working logic BACKTalk Programmable Logic Controller.</li> </ul> <b>Make; Honeywell, Delta,SIEMENS</b>	No	1		
23	Repairing of existing 36 TR scroll chiller- SITC of power supply and temperature sensor 02 nos complete as required <b>Make; Bluestar</b>	Lot	01		
24	SITC of centrifugal monoblock end suction pump 5 HP for circulating chilled water ,flow rate 9.5 lps for chiller complete with TEFC motor. The pumps shall be suitable for operation on 415+- 10% volts.3 phase 50 Hz AC power supply ,Body CI,BRASS IMPELLER,HEAD-25-30 MTR pump base channel, drain line ,cable connection motor shelter complete as required. <b>Make; Kirloskar,KSB,Armstrong</b>	No	02		

## Renovation of SCID mice facility (1<sup>st</sup> Floor) and Transgenic mice facility (Ground Floor) in Animal House

25	SITC of <b>3 - Door Interlock system</b> with Electromagnetic Strike lock unit +Egress Button. <b>Make; Honeywell,Alarton, ESSL</b>	No	1		
26	<b>SITC of Access control</b> & Egress Button system addressable type with ProximityCard or Finger tips scanner syste. <b>Make; Honeywell,Alarton, ESSL</b>	No	1		
27	<b>SITC of CCTV camera-</b>  IP Hikvision Dome camera 2mp4mm with laying of cat 6 cable and power cable with one additional DVR and interlink with our existing CCTV <b>Make; IP Hikvision</b>		5		
28	<b>SITC of UPS 20 KVA</b>  20KVA 3PH IN , 3PH OUT , EXIDE/QUANTA 12V 42AH 32NOS , BREAKER, LINK AND CABLE SET, BATTERY RACK, FOUR POLL MCCB 100AMP-2NOS FOR I/P AND O/P WITH BOX (MAKE HAVELLS) AND CABLING AND I/P , O/P CABLE FROM MCCB TO UPS INPUT AND OUTPUT WITH 2 YEARS WARRANTY – <b>Make; EATON/VERTIV</b>		1		
29	<b>FIRE ADDRESS SYSTEM</b>  <b>Smoke detector compatible with our existing fire panel, laying of armored cable and provision to link all the detectors with our existing panel and provision to make integrated with fire damper</b> <b>Make; Appolo</b>		20		
	<b>Testing, Validation &amp; SOP</b>				
30	Validation, Testing and Documentation of CLEAN Lab Facility <b>Operation manual ( SOP)</b> <b>Facility drawing attached it will show desired temperature, humidity , pressure and all parameters.</b>	Job	1		
31	<b>Dismantling and Removal of Existing installations like AHU, exhaust, ducting, chiller pipe, electric panel, lab puff panel, cutting RCC walls, painting and Civil &amp;Structural work as required as per approved drawing</b>	Lot	1		

**Renovation of SCID mice facility (1<sup>st</sup> Floor) and Transgenic mice facility (Ground Floor) in Animal House**

32	<p><b>SITC of Equipment shed</b> Supply &amp; installation of percolated galvanized iron profile sheets (Metro Sheet) (size, shape and pitch of corrugation as approved at site) 0.50 mm +/- 5% total coated thickness (TCT) thick Zinc coating 120gsm as per IS: 277 in 240mpa steel grade, 5-7 microns' epoxy primer on both side of the sheet and polyester top coat 15- 18 microns. Sheet should have protective guard film of 25 microns minimum to avoid scratches while transportation and should be supplied in single length up to 12 meter. The sheet shall be fixed using self-drilling / self-tapping screws of size (5.5x 55mm) with EPDM seal or with polymer coated J or L hooks, bolts and nuts 8mm diameter with bitumen or with G.I. limpet washers filled with white lead complete up to any pitch in horizontal/ vertical or curved surfaces including cutting to size and shape wherever required. <b>including MS squire pipe (32x32x5) structure complete as required. (Squire pipe make;Tata,Jintal)</b>  <b>Make; Tata, Jintal</b></p>	Sq.mtr	50		
<b>TOTAL (A)</b>					
B	<p><b>RENOVATION OF CLEAN ROOM FACILITY - GROUND FLOOR ANIMAL HOUSE</b></p>				
1	<p><b>Dismantling and Removal of Existing installations like AHU, Exhaust system, Pan humidifier, Chiller piping, Ducting, Dabries &amp; Re-construction of equipment foundations and Shed complete with Civil &amp; Structural work as required as per approved drawing. INCLUDING necessary Wall and Ceiling Painting repairing and process painting as</b></p>	LOT	1		
	<p><b>Air Conditioning System.</b></p>				



**Renovation of SCID mice facility (1<sup>st</sup> Floor) and Transgenic mice facility (Ground Floor) in Animal House**

2	<p><b>Supply, installation, testing and commissioning of DOUBLE DECKER AHU3000 CFM - -: TFA type 100% FA 140mmWG Static pressure Modular Outdoor TFA Double skin Air Handling Units of 43+/-2 mm thick PUF injected panels</b> with 24 gauge GI inner skin and pre-coated GI outer skin all as per specification including fan with TEFC motor. AHU shall have Air intake louver combined with pre filter (EU-3), Fine Filter section (EU-9),HEPA filter section (EU-13), coil section with DX 6-Row coil, blower section with DIDW centrifugal fan having static pressure of 140 mm/Wg foundation, GI drainage complete as required. <b>Make; Waves, citizen,ZECO</b></p>	No	2		
3	<p><b>Supply, installation, testing and commissioning of DOUBLE DECKER AHU 2000 CFM -: TFA type 100% FA 140mmWG Static pressureModular Outdoor TFA Double Skin Air Handling Units of 43+/-2 mm thick PUF injected panels</b> with 24-gauge GI inner skin and pre-coated GI outer skin all as per specification including fan with TEFC motor. AHU shall have Air intake louver combined with pre filter (EU-3), Fine Filter section (EU-9),HEPA filter section (EU-13), coil section with DX 6-Row coil, blower section with DIDW centrifugal fan having static pressure of 140 mm/Wg foundation,GI drainage complete as required. <b>Make; Waves, citizen,ZECO</b></p>	No	4		
4	<p>SITC of Pan Humidifier (SS-304) complete with SS Tank and Emerson Heaters of capacity 9 Kw electrical rating and connected distribution piping and mist-nozzles inside the AHU air stream, including GI piping for water connections, water high level low level sensors, over temperature cut out, drain line, required ball valves (Make zoloto, Unic) for smooth operation of the system, foundation complete as required. <b>Make; Rapid cool,KEPL</b></p>	No	4		
5	<p><b>SITC of exhaust system 2400 CFM Double skin EXHAUST Air Plenum of 25+/-2 mm thick PUF injected panels</b> with 24-gauge GI inner skin and pre-coated GI outer skin all as per specification including fan with <b>TEFC motor</b>. EAU shall have Exhaust Damper, combined with HEPA filters (EU-13), blower section with INLET &amp; OUTLET Dampers <b>foundation complete as required.</b> <b>Make; Waves, citizen,ZECO</b></p>	No	2		

**Renovation of SCID mice facility (1<sup>st</sup> Floor) and Transgenic mice facility (Ground Floor) in Animal House**

6	<b>SITC of exhaust system 1600 CFM Double skin EXHAUST Air Plenum of 25+/-2 mm thick PUF injected panels with 24-gauge GI inner skin and pre-coated GI outer skin all as per specification including fan with TEFC motor. EAU shall have Exhaust Damper, combined with HEPA filters (EU-13), blower section with INLET &amp; OUTLET Dampers foundation complete as required. Make; Waves, citizen,ZECO</b>	No	4		
7	<b>SITC of following size Chiller piping MS C Class pipe with 32mm Nitrile Insulation and Aluminium Cladding 26G/ UV Protection Coating, L bow,T,C channel, pipe supports complete as required.( Insulation Make;Armaflex, vidoflex)</b>				
7.1	<b>100 mm dia . Make; Jindal,Tata</b>	Mtr.	80		
7.2	<b>50 mm dia. Make; Jindal,Tata</b>	Mtr.	50		
7.3	<b>32 mm dia Make; Jindal,Tata</b>	Mtr.	20		
8	<b>SITC of 3 WAY MOTORIZED VALVE 50 mm dia linier type, thermostat, Auto /Manual function, interconnecting wires, flenges, nut, bolt, insulation with aluminium cladding complete as required. Make; Siemens,Honeywell</b>	No	5		
9	<b>SITC of BUTTERFLY VALVE of following size flenges, nut, bolt, insulation with aluminiumclading complete as required. Make; Audco,Advance</b>				
9.1	<b>50 mm dia</b>	No	32		
9.2	<b>32 mm dia</b>	No	1		
10	<b>SITC of Y type pipe line strainers of following size duly insulated and necessary fittings complete as required. Make; Audco,Advance</b>				
10.1	<b>50 mm dia</b>	No	6		
11	<b>SITC of PRESSURE GAUGE 0-10 kg/sq cm,100mm dial size, SS syphan with ss ball valve fittings complete as required. Make; H Guru,Jaspin</b>	No	12		

**Renovation of SCID mice facility (1<sup>st</sup> Floor) and Transgenic mice facility (Ground Floor) in Animal House**

12	<b>SITC of Mercury filled 'V' form thermometer with SS/browns body, thermo well for AHU complete as required. Make; H Guru,Jaspin</b>	No	12		
13	<b>SITC of Heavy duty isolating ball valve 1/2 inch with fittings for AHU water air purging complete as required. Make; Zoloto,Unic</b>	NO	08		
	<b>Air Distribution System</b>				
14	<b>SITC of GI Ducting complete with MS painted flanges, all joints sealed with RTDsilicon sealant with MS painted supports as per IS-266 with Zinc deposition 120gms/sqm. Make; Jindal,Tata</b>				
14.1	GSS-22Swg ducting including accessories and Support arrangement complete as required	Sqm.	50		
14.2	GSS-24 Swg ducting including accessories and Support arrangement complete as required	Sqm.	100		
14.3	<b>SITC of Duct Insulation with 19 mm thick aluminium foil faced / Nitrile Class-O and alljoints shall be provided with 2" fixing tape complete as required. Make; Armaflex, vidoflex</b>	Sqm	150		
14.4	GI duct cladding with GSS-26 Swg sheet complete as required. <b>Make; Jindal, Tata</b>	Sqm	150		
14.5	Extruded aluminium powder coated Supply/ Exhaust Air Diffusers with Black Matt Finish VCD <b>Make; Caryair, Waves</b>	Sq.m	3		

**Renovation of SCID mice facility (1<sup>st</sup> Floor) and Transgenic mice facility (Ground Floor) in Animal House**

15	<p><b>SITC of FIRE DAMPER SUITABLE SIZE</b>                  Supplying, Fixing, testing and commissioning of fire dampers in supply air duct/ main branch and return air path as and where required of required sizes i/c control wiring, the damper shall be motorized and spring return so as to close the damper in the event of power failure automatically and open the same in case of power being restored. The spring return action shall be inbuilt mechanism and not externally mounted. The damper shall also be closed in the event of fire signal control wire should connected to the existing fire panel complete as required and as per CPWD specifications, wiring/power supply complete as required..  <b>Make; Caryair, Waves</b></p>	No	06		
16	<p>SITC of Aluminium Gear Operated volume control dampers suitable size with actuators with wiring for AHU and Exhaust systems f complete as required.  <b>Make; Caryair, Waves</b></p>	No	12		
17	<p>Servicing of Existing Electrical installetions including necessary replacement of defective components as per site.  <b>Make; L&amp;T,SCHNEIDER,ABB</b></p>	Lot	1		
18	<p>SITC of new set of <b>Light Fixtures with 2x18 Watt LED lights</b> and accessories.  <b>Make; Philips,Havells,panasonic</b></p>	No	56		
19	<p><b>CLEAN lab interior &amp; clean room</b></p>				
19.1	<p>Complete dismantling and replacement of the existing <b>Wall PU Painting</b> with Water Based Surface treatment and finishing Existing clean room facility ground floor.  <b>Make; Berger,Asian</b></p>	Lot	1		
19.2	<p>Supply &amp; Installation of <b>New Air Tight Door of size: 820 x 2100.</b>  <b>Fabtech,clean room systems, Synergy</b></p>	No	1		
19.3	<p><b>SITC of Thermal welded PVC flooring 2 MM thickness complete as required.</b>  <b>Make; Wonder floor,RMG</b></p>	Sq.m	150		

## Renovation of SCID mice facility (1<sup>st</sup> Floor) and Transgenic mice facility (Ground Floor) in Animal House

20	SITC of Upgrading and calibration of existing <b>BMS &amp; Automation System</b> at site including required sensors, spares and wiring complete as required. <b>Make; Honeywell</b>	Job	1		
21	Servicing of Existing <b>Dynamic and Static Pass Boxes</b> as per site	No	2		
22	Servicing of existing <b>Door Interlock system</b> with Electromagnetic Strike lock unit + Egress Button existing facility complete as required	Job	1		
23	<b>Servicing and replacement of air filters in air shower installed in ground floor clean room facility complete as required.</b>	Job	1		
24	<b>SITC of HEPA &amp; PREE FILTERS in clean room facility. Size - 610x610x150 mm,500 cfm, Make; Thermodyne,AAF</b>	No	12		
25	Servicing and Replacement of <b>Filters</b> in Animal Change Station installed in clean room facility	No	2		
26	Supply & installation of percolated galvanized iron profile sheets (Metro Sheet) fixing in existing structure (size, shape and pitch of corrugation as approved at site) 0.50 mm +/- 5% total coated thickness (TCT) thick Zinc coating 120gsm as per IS: 277 in 240mpa steel grade, 5-7 microns' epoxy primer on both side of the sheet and polyester top coat 15- 18 microns. Sheet should have protective guard film of 25 microns minimum to avoid scratches while transportation and should be supplied in single length up to 12 meter. The sheet shall be fixed using self-drilling / self-tapping screws of size (5.5x 55mm) with EPDM seal or with polymer coated J or L hooks, bolts and nuts 8mm diameter with bitumen or with G.I. limpet washers filled with white lead complete up to any pitch in horizontal/ vertical or curved surfaces including cutting to size and shape wherever required. Including Existing structure repairing and painting complete as required. <b>Make; Tata,Jintal</b>	Sq.mtr	90		
	<b>Testing, Validation &amp; SOP</b>				

**Renovation of SCID mice facility (1<sup>st</sup> Floor) and Transgenic mice facility (Ground Floor) in Animal House**

27	Validation, Testing and Documentation of CLEAN Lab Facility. Facility maintained Temperature 23+_2 degree Humidity - 50% - 60% Pressure - 15 psi	Lot	1		
<b>TOTAL (B)</b>					
<b>C</b>	<b>Scrap items; Buy back</b>  1) AHU - 07 nos 2) Exhaust system - 07 nos 3) Electric panel - 01 no 4) Pan humidifier - 01 no 5) Chiller pump 5 HP - 02 NOS 6) old ducts, and iron scrap	Lot	1		
<b>GRAND TOTAL (A+B-C)</b>					

**Approved make: All supports and Chanel - Tata, Jindal  
Paint - Berger, Asian**

Note: -

1. Abnormally low and high bid will not be entertained.
2. GST should be mentioned separately.
3. Before quoting the rates, the Contractors should inspect the works at campus of ICGEB.
4. Fill the price bid in Excel format.

Authorised Signatory  
Name & Address of the firm with seal