

TENDER DOCUMENTS

**MW-04/2024**

FOR

**Fabrication of Book Case**

AT

INTERNATIONAL CENTRE FOR GENETIC ENGINEERING & BIOTECHNOLOGY (ICGEB)

Aruna Asaf Ali Marg, New Delhi – 110067

Website: [www.icgeb.res.in](http://www.icgeb.res.in)

(1)

**IMPORTANT INFORMATION**

<b>Tender No.</b>	MW-04/2024.
<b>Tender Fee</b>	Tender Fee of Rs 500/-(Five hundred Rupees only) in the form of separate demand draft to be drawn in favour of International Centre for Genetic Engineering & Biotechnology payable at New Delhi.
<b>Last Date and time for Bid Submission</b>	1 <sup>st</sup> July, 2024 till 3:00 PM.
<b>Address at which Bid is to be submitted</b>	Should be dropped in the tender box at the reception of International Centre for Genetic Engineering & Biotechnology, Aruna Asaf Ali Marg, and New Delhi – 110067.
<b>Date, Time &amp; Place of opening of the Financial Bid</b>	1 <sup>st</sup> July, 2024 at 4:00 PM in ICGEB.

(2)

**Scope of Work**

Scope of work is Fabrication of Book Case in accordance with Drawing No. ICGEB/CIVIL/03/2024 (attached herewith), Bill of Quantities (attached) in price Bid and Technical specification

**DRAWING (WOODEN Book Shelf)**

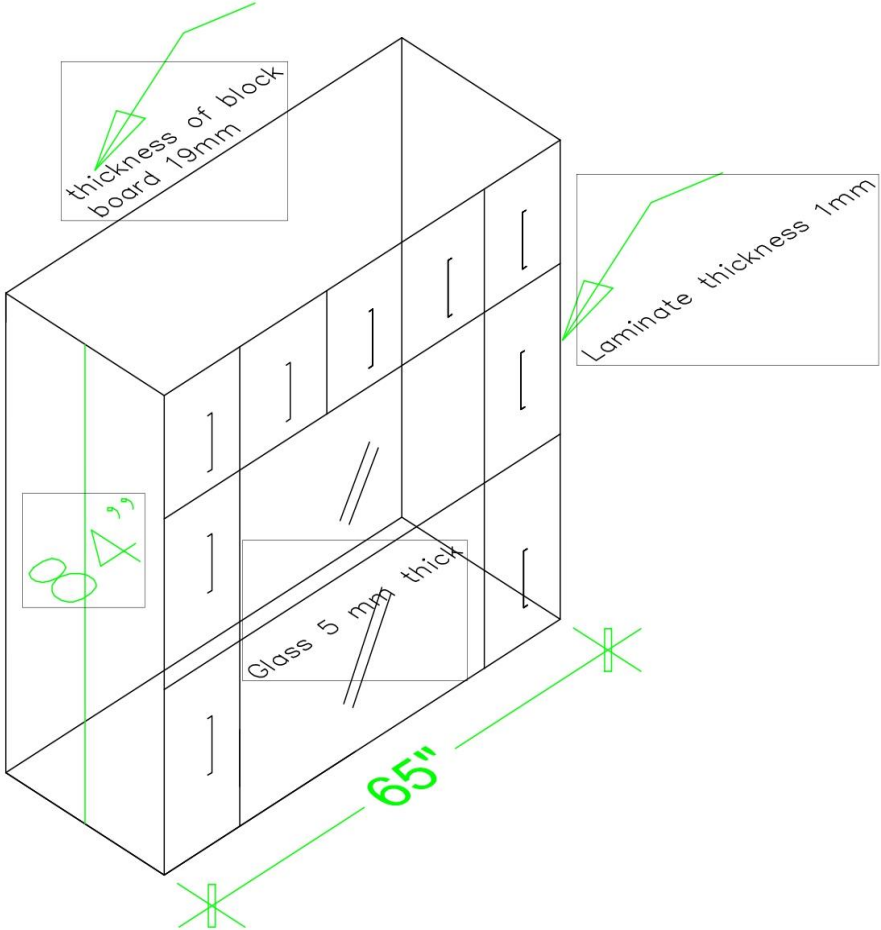

(3)

**TERMS OF PAYMENT**

**1. Payment of bills:**

100 % payments after satisfactory completions of work.

- 2. Security deposit of 10 %** will be deducted from the Contractors bills and same will be released after successful expiry of defect liability of 12 months from date of completion of Work.

(4)

Annexure – A

This certificate shall be furnished duly signed & stamped with Techno-commercial Bid.

**Site Visit Certificate/ Undertaking**

This is to certify that we have visited the site for work of **Fabrication of Book Case** on ..... and assessed the actual situation & nature of site. We have also assessed the amount of work involved at site for tendered work before submitting our offer. We will be able to complete the above work within stipulated time as per site conditions.

We further undertake that no extra cost will be claimed by us later-on for any difficulties/ modifications involved during the execution of tendered works. We understand that work is to be executed in an already operational/ functional institute.

Component In-Charge  
ICGEB New Delhi

Authorised Signatory  
Name & Address of the firm with seal

(5)

**PRICE BID (Schedule of Rate)****Name of Work: Fabrication of Book Case.**

Sr. No	DESCRIPTION OF ITEM	QTY	UNIT	RATE	AMOUNT
1	Providing and fixing at site Size of wooden shelf (84"x65"x17") deep Book shelved Cupboard to be made up of 19 mm BWP ply with shelves. The cupboard shall have open racks also sliding glass 5 mm thick. the open shelves are to be finished with approved shade of 1.0mm thick laminated finish on all the sides, The cost shall include all materials, labour, all accessories, such as handles, catchers, etc Complete . <b>Make - Ply wood - Century ply, Green Ply, Fittings - Godrej , Hattich ,</b>	42	Sqft		
	Total				

**Note:**

1. Abnormally low and high bid will not be entertained.
2. GST should be mentioned separately.
3. Before quoting the rates, the Contractors should inspect the works at campus of ICGEB.
4. Fill the price bid in Excel format.

Authorised Signatory  
Name & Address of the firm with seal